

N

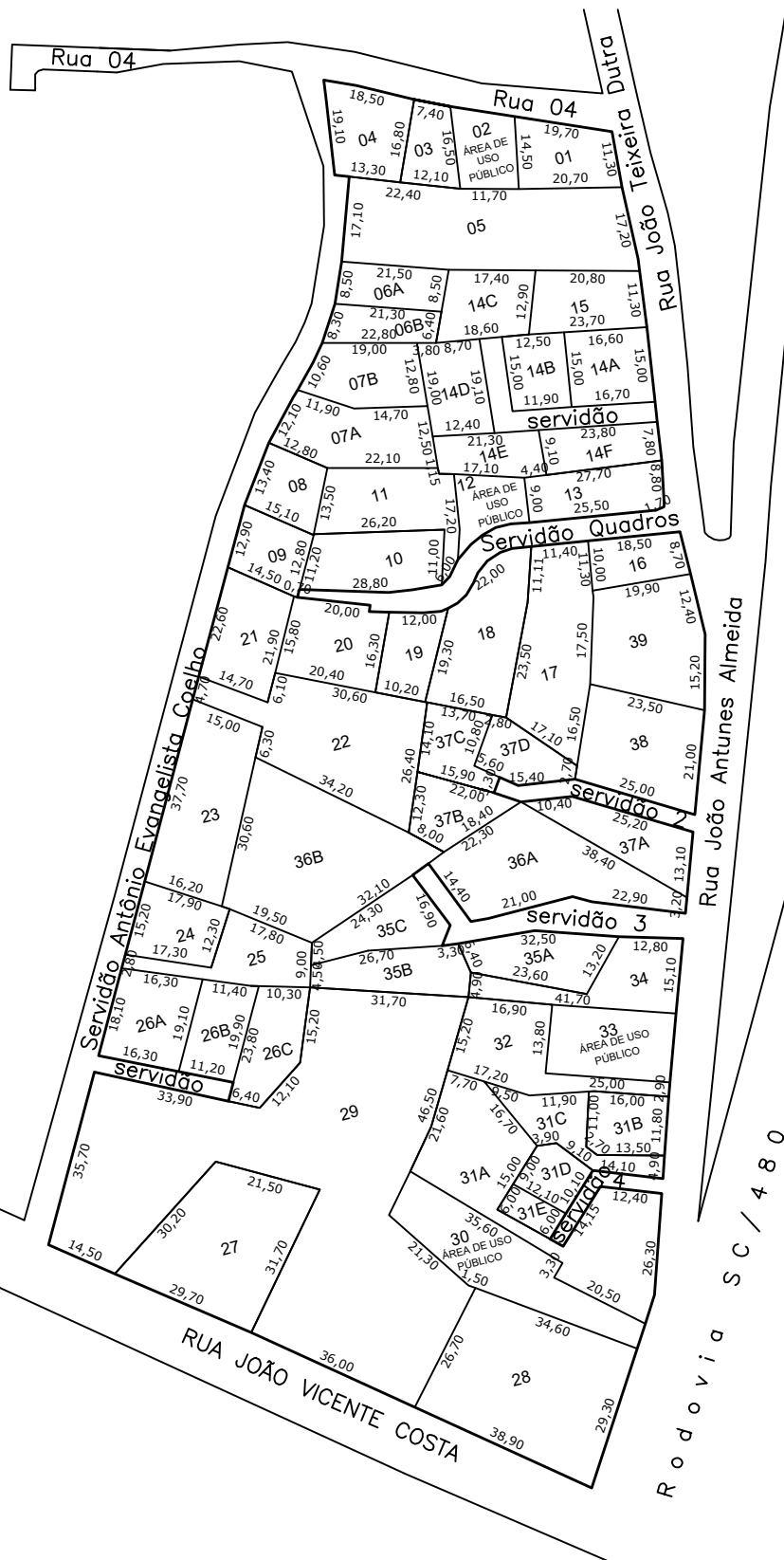
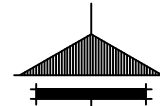

Prefeitura Municipal de
Chapecó

Projeto: **Loteamento Marechal Bormann**

Obra: **Bairro Distrito Marechal Bormann**

Referente: **Quadra 10 - MB**

Escala: 1/1500

Data: 2021

Desenho: DANIELLE

Revisão: ---

Nº Projeto: ---

Unica